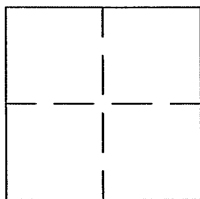

## CORNER RECORD

BK 56PG 26CR- 3394APN No. 84A-20,35,51- (Optional) Document NumberCASTRO VALLEY-UNINCORPORATEDCounty of ALAMEDA, CaliforniaBrief Legal Description NEW MONUMENT AT CURVE PI NEAR STATION 26+50.

## CORNER TYPE

Government Corner ☐Control ☐Meander ☐Property ☐Rancho ☐Other ☒Date of Survey MAY, 2001COORDINATES  
(Optional)

N. \_\_\_\_\_

E. \_\_\_\_\_

Zone \_\_\_\_\_ Datum \_\_\_\_\_

Elev. \_\_\_\_\_

Corner — Left as found ☐ Found and tagged ☐ Established ☐ Reestablished ☒ Rebuilt ☐

In compliance with Section 8771 of the Professional Land Surveyors' Act, this corner record is being filed to ESTABLISH \_\_\_\_\_ / REESTABLISH X the position of an existing monument PRIOR \_\_\_\_\_ / SUBSEQUENT X to street or highway reconstruction. (Use this portion only when applicable.)

Identification and type of corner found: Evidence used to identify or procedure used to establish or reestablish the corner: THE MONUMENT DESCRIBED BELOW WAS SET USING THE MONUMENT REFERENCE POINTS FROM CR-1149 & CR-1158, AND AS SHOWN ON DRAWING "K-3837.

A description of the physical condition of the monument as found and as set or reset: A STANDARD COUNTY WELL MONUMENT WITH NIPPLED BRONZE DISK, WAS SET AT THE PI OF THE CURVE AT ABOUT STATION 27+00. THE MONUMENT IS AT THE PI, 37.50 FEET WESTERLY OF THE EXISTING BC STATION 26+26.04. SEE PAGE 2 FOR STAMPING.

## SURVEYOR'S STATEMENT

This Corner Record was prepared by me or under my direction in conformance with the Land Surveyors' Act on 6/12/ 2008.

Signed Gregory Donald Hollfelder L.S. or R.C.E. Number 5918

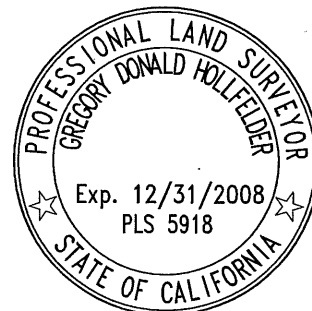

## COUNTY SURVEYOR'S STATEMENT

This Corner Record was received 6-12 2008 and examined and filed 11-17-2013

Signed Richard Penland Title County Surveyor



County Surveyor's Comment \_\_\_\_\_

ALA. CO. STATION 15+12.42 (See CR-1149)

NUNES AVE.

HOUSE ON  
2780 NORBRIDGE AVE.

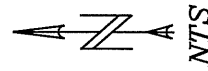

N89°55'56" E 1113.62 (1113.65 measured)  
MONUMENT LINE

NORBRIDGE AVE.

REF. ALAMEDA COUNTY MAPS:

CR 1149, 8CR42

CR 1158, 8CR44

BB-3837

K-3837 (MAP INFORMATION NOT USED)

(SET NAIL FROM CR-1158) ALA. CO. STATION 26+26.04

HOUSE

37.50

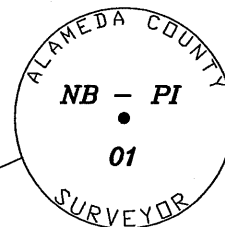

CURVE DATA:  
R=2998.00  
L=75.00  
 $\Delta=1^{\circ}26'00''$

LEGEND:

- = SET MONUMENT WITH BRASS DISK
- = FOUND NAIL SPREADERS FLUSH WITH GROUND.

SOUND WALL