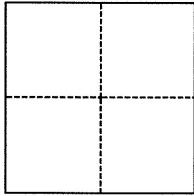

CORNER RECORD

Agency Index

BK 110 PGL49

Document Number 11389

City of Hayward County of Alameda, CaliforniaBrief Legal Description Monument near 25568 Camino Vista**CORNER TYPE**

- ☐ Government Corner ☒ Control
☐ Meander ☐ Property
☐ Rancho ☐ Other

Date of Survey 4/13/18**COORDINATES (Optional)**

N. _____ E. _____

Elevation _____

Units ☐ Metric ☒ U.S. Survey Foot

Horizontal Datum _____

Zone _____ Epoch Date _____

Vertical Datum _____

☐ Complies with Public Resources Code §§8801-8819☐ Complies with Public Resources Code §§8890-8902

PLS Act Ref.:

☐ 8765(d)☒ 8771☐ 8773☐ Other:Corner/
Monument:☐ Left as found☐ Established☐ Rebuilt☒ Pre-Construction☐ Found and tagged☐ Reestablished☐ Referenced☐ Post-Construction

Narrative of corner identified and monument as found, set, reset, replaced, or removed:

☐ See sheet #2 for description(s):

City monument, found in good condition.

SURVEYOR'S STATEMENT

This Corner Record was prepared by me or under my direction in conformance with

the Professional Land Surveyors' Act on

April 17, 2018

Signed

P.L.S. or R.C.E. No.

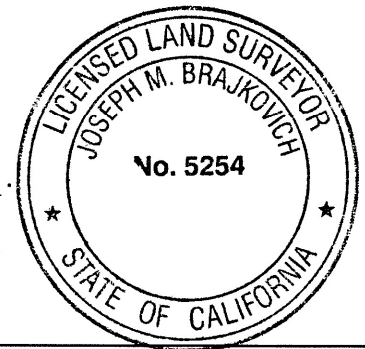
5254**COUNTY SURVEYOR'S STATEMENT**

This Corner Record was received

16 MAY 2018

and examined and filed

20 JULY 2018

Signed

P.L.S. or R.C.E. No.

6843

Title

COUNTY SURVEYOR

County Surveyor's Comment

