

MKS DLC32-WEB manual

1. Wi-Fi Connection

a.Click "Tool"

b.Click "WIFI"

c.Choose Wi-Fi

d.After entering password, click the icon. (If you have entered password, you can skip this and click the icon next time.)

e.After connection, you will be given an IP address. Type the address into your browser and enter the WEB control interface.

1.1 After connection, you will be given an IP address.

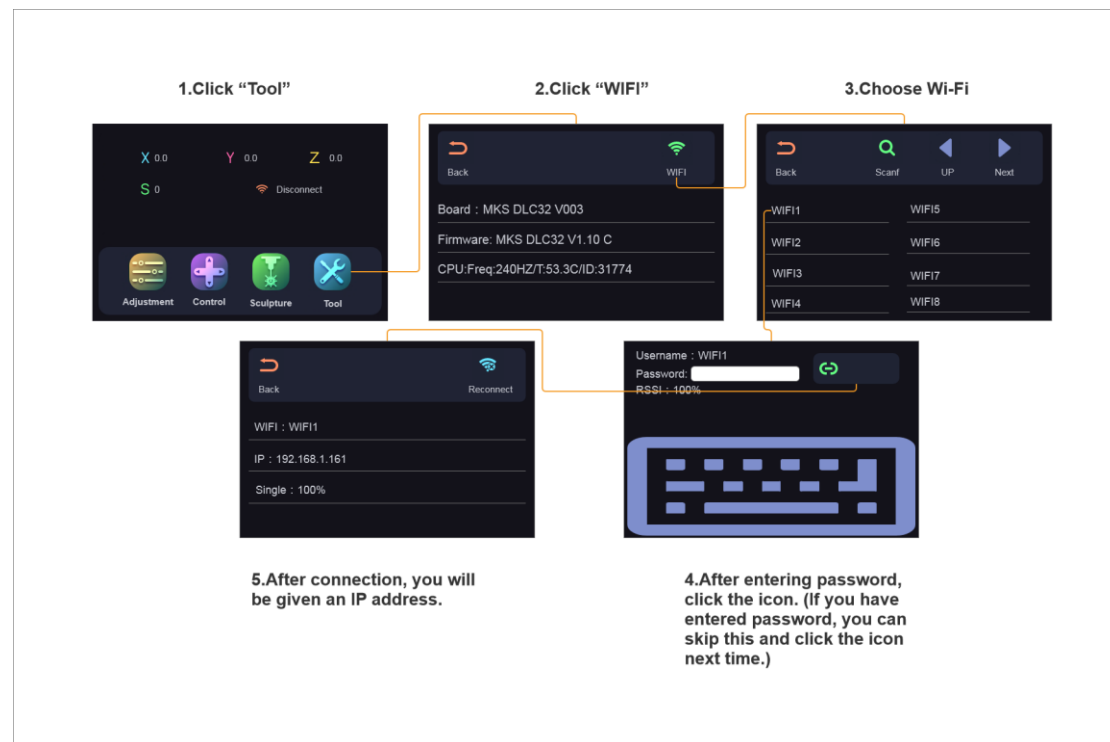

2.Unload data package

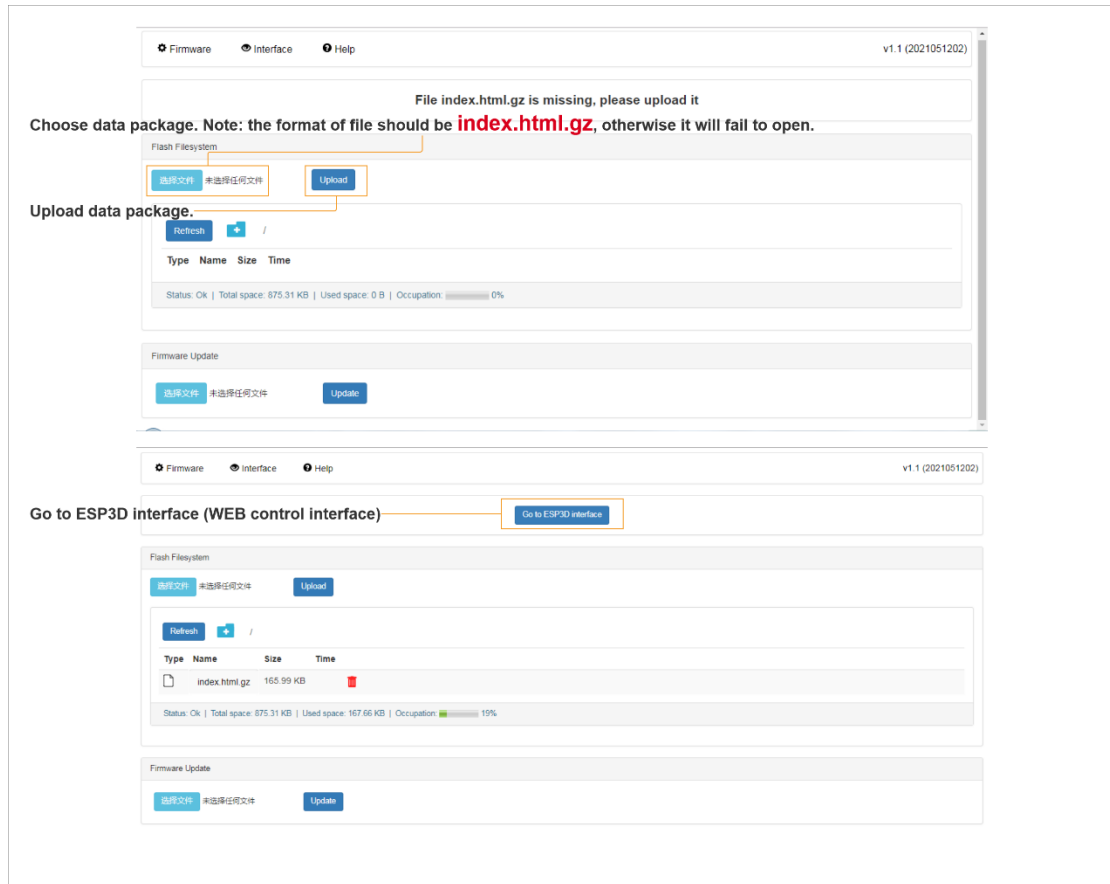

Note: the format of file should be "index.html.gz", otherwise it will fail to upload. When upload error is displayed, you can enter the control interface through the spare URL: <http://192.168.1.192/?index=yes>. And "192.168.1.192" is the allocative address.

3. WEB Control

3.1 Control interface

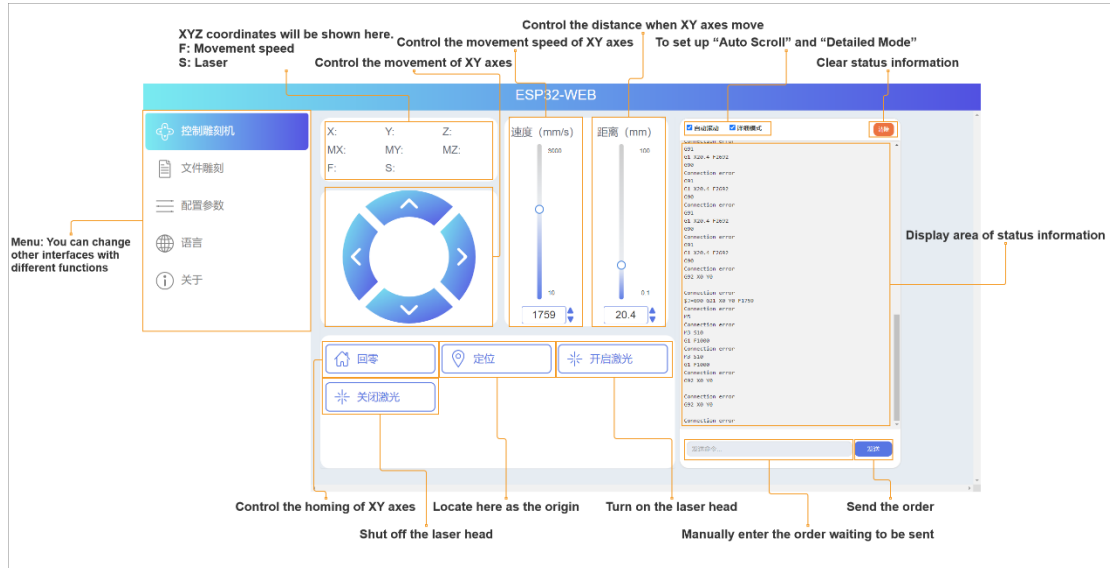

3.2 Engraving interface



3.3 Parameter setting

Refresh mainboard parameters

Set up the new one

The parameter waiting to be changed

Description of the parameter

ESP32-WEB

控制雕刻机

文件雕刻

配置参数

语言

关于

标识	值	单位	参数	描述
Set \$0	10	microseconds	Step pulse time	Sets time length per step. Minimum 3usec.
Set \$1	5	milliseconds	Step idle delay	Sets a short hold delay when stopping to let dynamics settle before disabling steppers. Value 255 keeps motors enabled with no delay.
Set \$2	0	mask	Step pulse invert	Inverts the step signal. Set axis bit to invert (00000ZYX).
Set \$3	1	mask	Step direction invert	Inverts the direction signal. Set axis bit to invert (00000ZYX).
Set \$4	0	boolean	Invert step enable pin	Inverts the stepper driver enable pin signal.
Set \$5	1	boolean	Invert limit pins	Inverts the all of the limit input pins.
Set \$6	0	boolean	Invert probe pin	Inverts the probe input pin signal.
Set \$10	1	mask	Status report options	Alters data included in status reports.
Set \$11	0.010	mm	Junction deviation	Sets how fast Gribl travels through consecutive motions. Lower value slows it down.
Set \$12	0.002	mm	Arc tolerance	Sets the G2 and G3 arc tracing accuracy based on radial error. Beware: A very small value may effect performance.

Menu: You can change other interfaces with different functions

3.4 Language setting

Language selection

ESP32-WEB

Control

SD File

Settings

Language

About

简体中文

English

Menu: You can change other interfaces with different functions

3.5 About

