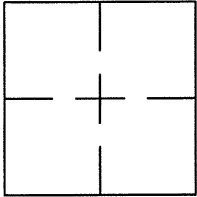

**CORNER RECORD**Document Number CR 7826UNINCORPORATED EDEN TOWNSHIPCounty of ALAMEDA, CaliforniaBrief Legal Description PK. NAIL LOCATED WITHIN THE INTERSECTION OF LIBERTY STREET AND 162ND AVENUE.**CORNER RECORD**

Government Corner ☐ Control ☒  
 Meander ☐ Property ☐  
 Rancho ☐ Other ☐  
 Date of Survey 11/21/2015

**COORDINATES**  
(Optional)

N. 2081971±  
 E. 6095293±  
 Zone \_\_\_\_\_ Datum \_\_\_\_\_  
 Elev. \_\_\_\_\_

**Corner** — Left as found ☒ Found and tagged ☐ Established ☐ Reestablished ☐ Rebuilt ☐

Identification and type of corner found: Evidence used to identify or procedure used to establish or reestablish the corner:  
FOUND PK NAIL LOCATED WITHIN THE INTERSECTION OF LIBERTY STREET AND 162ND AVENUE.  
LOCAL STRADDLE POINTS SET AND PK NAIL WAS REMOVED. SUBJECT AREA THOROUGHLY SEARCHED, NO ADDITIONAL MONUMENT FOUND.

THIS POINT WAS REFERENCED PRIOR TO A CONSTRUCTION PROJECT IN THE VICINITY.

A description of the physical condition of the monument as found and as set or reset: \_\_\_\_\_  
FOUND AND SET POINTS AS SHOWN ON PAGE 2.

THESE TIES ARE FOR THE PURPOSE OF PERPETUATING THE FOUND MONUMENTATION.

NO CLAIM IS MADE AS TO THE RELATIONSHIP OF THE POINTS OR LINES SHOWN HEREON TO TRUE BOUNDARY LOCATIONS.

**SURVEYOR'S STATEMENT**

This Corner Record was prepared by me or under my direction in conformance with the Land Surveyors' Act on December 3, 2015.

Signed Scott V. Cunha L.S. Number 8525 Exp. 12/31/16

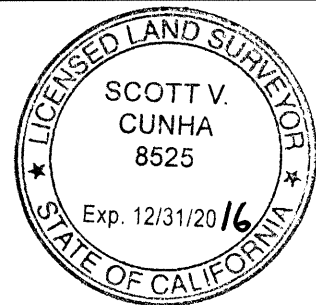
**COUNTY SURVEYOR'S STATEMENT**

This Corner Record was received 12-07 2015 and examined and filed 12-21 2015.

Signed Albert Jordan Title Deputy County Surveyor



County Surveyor's Comment \_\_\_\_\_

SPEC 2261-PRE

R23427



SCALE: 1"=30'

## LEGEND

- FOUND BRASS DISC WITH PUNCH IN MONUMENT WELL
- △ FOUND RAILROAD SPIKE
- FOUND PK NAIL
- SET REBAR & CAP
- ⊗ SET CUT CROSS IN WALK
- × SET PK NAIL & LARGE SHINER
- × SET CUT CROSS IN CURB
- AA##A# ALAMEDA COUNTY MONUMENT ID

(19592) STREET ADDRESS

