

# CORNER RECORD

Agency Index BK 106 PG 54Document Number CR 10811City of CASTRO VALLEYCounty of ALAMEDA, CaliforniaBrief Legal Description JF38Y2 (CAMINO ALTA MIRA)

## CORNER TYPE

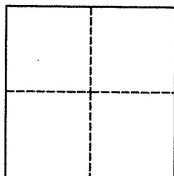

Government Corner ☒ Control  
Meander ☐ Property  
Rancho ☐ Other

Date of Survey 09/28/2017

## COORDINATES (Optional)

N. \_\_\_\_\_ E. \_\_\_\_\_

Elevation \_\_\_\_\_

Units Metric ☐ U.S. Survey Foot ☒

Horizontal Datum \_\_\_\_\_

Zone \_\_\_\_\_ Epoch Date \_\_\_\_\_

Vertical Datum \_\_\_\_\_

☐ Complies with Public Resources Code §§8801-8819☐ Complies with Public Resources Code §§8890-8902

PLS Act Ref.:

☐ 8765(d)☒ 8771☐ 8773☐ Other:Corner/  
Monument:☐ Left as found☐ Established☐ Rebuilt☐ Pre-Construction☐ Found and tagged☐ Reestablished☐ Referenced☒ Post-Construction

Narrative of corner identified and monument as found, set, reset, replaced, or removed:

☐ See sheet #2 for description(s):

FOUND 5/16" BRASS PIN FOUND IN CONCRETE FOR COUNTY MON IN MON WELL, DOWN 12",  
FOUND FOUR CUT "X" REFERENCES AND TIE TO HE27X1 PER CORNER RECORD CR 10525 AND  
AS SHOWN ON SHEET 2.

## SURVEYOR'S STATEMENT

This Corner Record was prepared by me or under my direction in conformance with

the Professional Land Surveyors' Act on NOVEMBER 9, 2017Signed James N. Landrum P.L.S. or R.C.E. No. LS 5837

## COUNTY SURVEYOR'S STATEMENT

This Corner Record was received 13 NOVEMBER 2017and examined and filed 10 APRIL 2018Signed Michael Rubner P.L.S. or R.C.E. No. 6843Title COUNTY SURVEYOR

County Surveyor's Comment

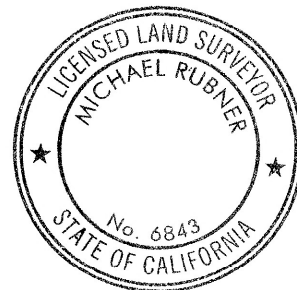

SPEC 2322

(PRE-CONSTRUCTION CR 10525)

**JF38Y2**

NO SCALE

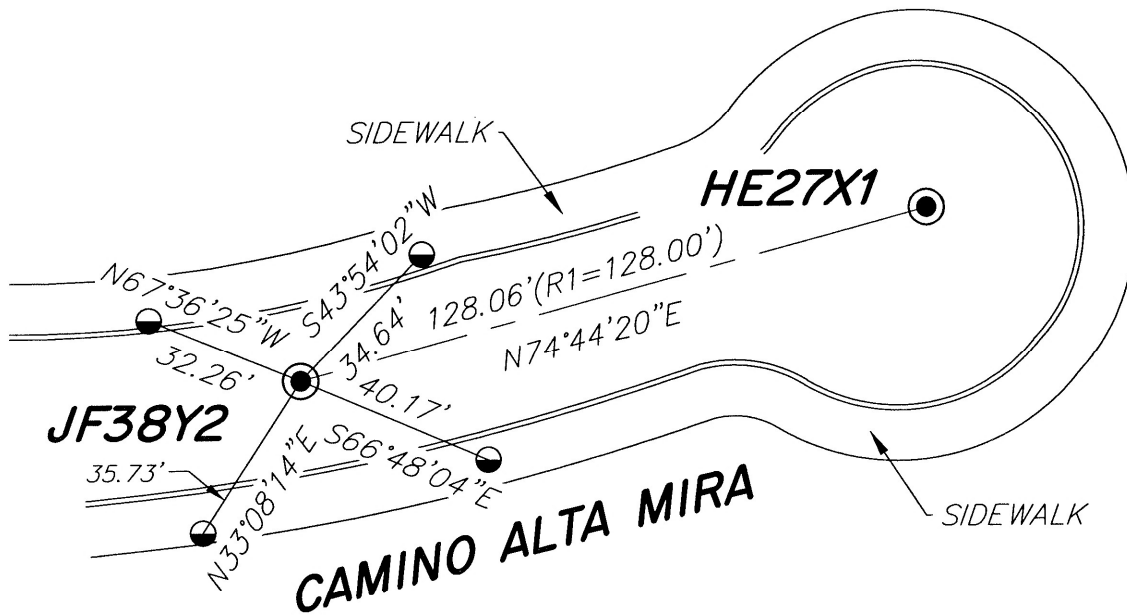
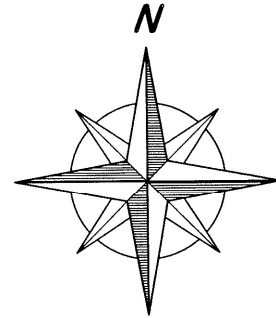
**LEGEND**

● FOUND ALAMEDA COUNTY MONUMENT  
AS NOTED ON SHEET 1

● FOUND CUT "X" UNLESS  
OTHERWISE SHOWN

AA##A# ALAMEDA COUNTY MONUMENT ID

**REFERENCE**

R1 TRACT 4712 BK150 AT PG 75

NOTE THAT BEARINGS ARE  
APPROXIMATE AND ARE TO  
BE USED FOR ANGLE  
CALCULATIONS ONLY.