

p:\2021\10\22 - rb american group - heber springs.mxd
p:\2021\10\22 - rb american group - heber springs.mxd
p:\2021\10\22 - rb american group - heber springs.mxd

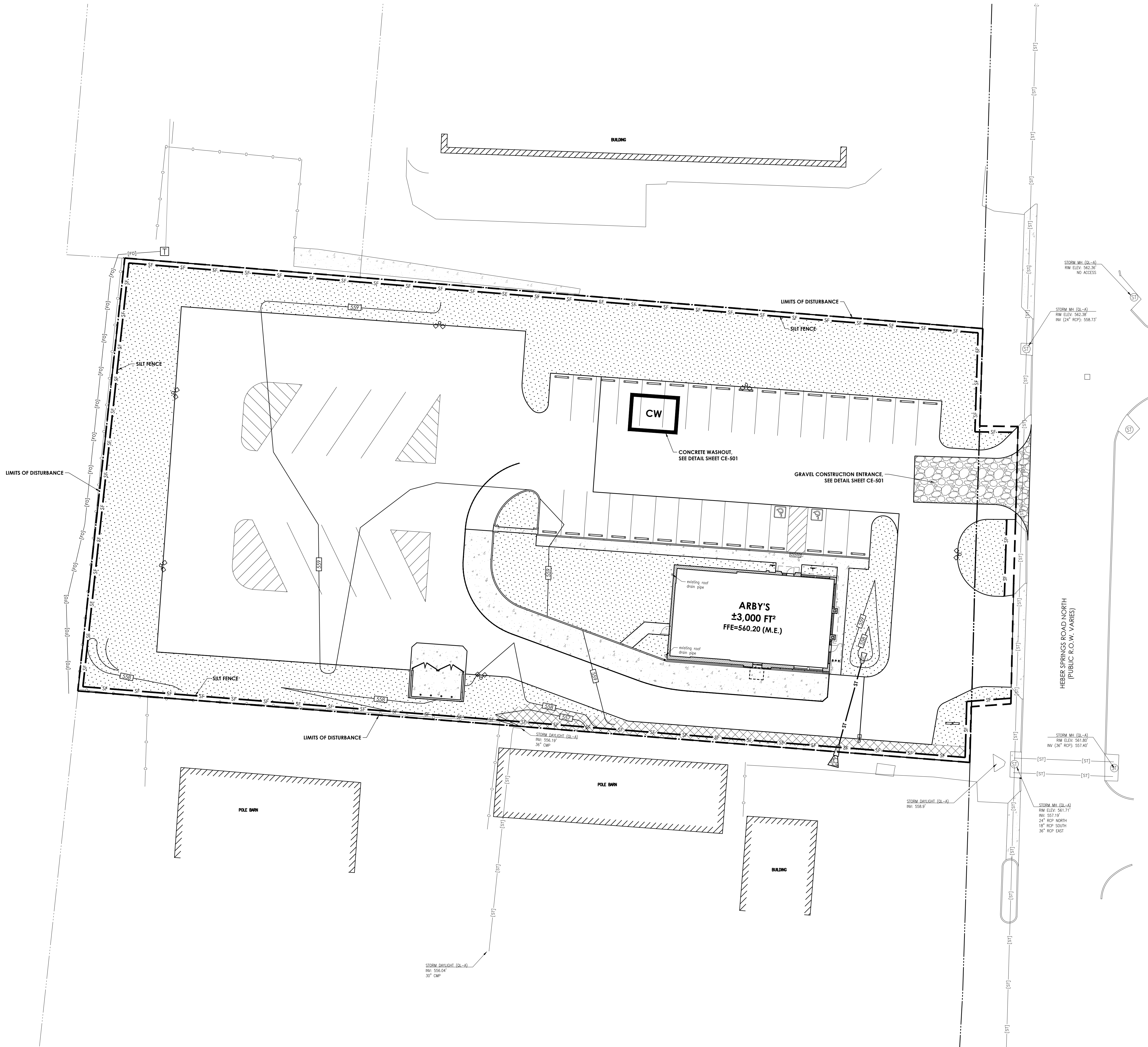

LEGEND OF EXISTING FEATURES

| | | | |
|-----|-----------------------|-------|-----------------------|
| --- | PROPERTY LINE | ⊕ | BENCHMARK |
| --- | RIGHT-OF-WAY LINE | ○ RBC | MONUMENT |
| --- | SETBACK LINE | △ | SECTION CORNER |
| --- | EASEMENT | ET HC | TRANSFORMER |
| --- | SECTION LINE | E M | HVAC |
| --- | CENTERLINE | E M | ELECTRIC METER |
| --- | 799 | ⊕ | ELECTRIC MANHOLE |
| --- | INTERMEDIATE CONTOUR | ⊕ | POWER POLE GUY WIRE |
| --- | 800 | ⊕ | LIGHT POLE |
| --- | INDEX CONTOUR | ⊕ | TELEPHONE PEDESTAL |
| --- | TELEPHONE UNDER GR. | ⊕ | TELEPHONE MANHOLE |
| --- | TELEPHONE OVERHEAD | ⊕ | GAS MARKER |
| --- | FIBER OPTIC SERVICE | ⊕ | ELECTRIC MANHOLE |
| --- | GAS SERVICE | ⊕ | TRAFFIC POLE |
| --- | POWER UNDERGROUND | ⊕ | TRAFFIC MANHOLE |
| --- | POWER OVERHEAD | ⊕ | GAS METER |
| --- | WATER SERVICE | ⊕ | GAS VALVE |
| --- | SANITARY SEWER | ⊕ | STORM MANHOLE |
| --- | STORM SEWER | ⊕ | SANITARY MANHOLE |
| --- | POND NORMAL POOL | ⊕ | STORM INLETS |
| --- | EX. FLOWLINE | ⊕ | CLEAN-OUT |
| --- | CHAIN LINK FENCE | ⊕ | DOWNSPOUT |
| --- | FARM FENCE | ⊕ | FIRE HYDRANTS |
| --- | WOOD FENCE | ⊕ | WATER METER |
| --- | IRON FENCE RAILING | ⊕ | WATER VALVES |
| --- | BUILDING STRUCTURE | ⊕ | POST INDICATOR VALVE |
| --- | EX. BUILDING OVERHEAD | ⊕ | FIRE DEPARTMENT CONN. |
| --- | RIM | ⊕ | SIGNS |
| --- | INV. | ⊕ | MAILBOX |
| --- | FFE | ⊕ | ADA PARKING |
| --- | | ⊕ | PARKING COUNT |
| --- | | ⊕ | TREES |
| --- | | ⊕ | SHRUB |
| --- | | ⊕ | SPOT GRADE |

STORMWATER POLLUTION PREVENTION PLAN LEGEND

| | | | |
|-----|------------------------------|-----|--------|
| --- | PROPOSED SEEDING | --- | CE-501 |
| --- | EROSION CONTROL MATTING | --- | CE-501 |
| --- | RIPRAP OUTLET PROTECTION | --- | CE-501 |
| --- | GRAVEL CONSTRUCTION ENTRANCE | --- | CE-501 |

| | | | | |
|-----|----------------------|-----|-----|------------------|
| --- | CONSTRUCTION LIMITS | --- | CW | CONCRETE WASHOUT |
| --- | SILT FENCE | --- | --- | INLET PROTECTION |
| --- | STORM SEWER | --- | --- | STORM MANHOLE |
| --- | SUBSURFACE DRAIN | --- | --- | STORM INLETS |
| --- | SWALE FLOWLINE | --- | --- | INVERT ELEVATION |
| --- | INTERMEDIATE CONTOUR | --- | --- | CLEAN-OUT |
| --- | INDEX CONTOUR | --- | --- | DOWNSPOUT |
| --- | FLOW ARROW | --- | --- | |

CONSTRUCTION SEQUENCE

PRE-CONSTRUCTION ACTIVITIES:

- CALL 811 SERVICE AT 811 TO CHECK THE LOCATION OF ANY EXISTING UTILITIES. THEY SHOULD BE NOTIFIED TWO WORKING DAYS BEFORE CONSTRUCTION TAKES PLACE.
- A SILT FENCE SHALL BE INSTALLED AT THE EDGES OF THE PROJECT SITE WHERE THERE IS POTENTIAL FOR ANY STORMWATER RUNOFF. POTENTIAL AREAS ARE IDENTIFIED BASED ON EXISTING TOPOGRAPHY AND SHOWN ON SHEET CE-101. THE INSTALLED SILT FENCE SHOULD BE INSPECTED AND ANY ACCUMULATING SEDIMENT REMOVED.
- EVALUATE EXISTING VEGETATION SUITABLE FOR USE AS FILTER STRIPS ALONG THE PROPERTY BOUNDARIES.
- A CONSTRUCTION ENTRANCE SHALL BE PLACED AS SHOWN ON SHEET CE-101.
- ESTABLISH CONSTRUCTION STAGING AREA FOR EQUIPMENT AND VEHICLES AS FAR FROM INLETS AND SWALES AS POSSIBLE.
- ESTABLISH ONSITE LOCATION FOR OWNER/OPERATOR/CONTRACTOR PLACEMENT OF APPROVED PLANS AND INSPECTION DOCUMENTATION.

CONSTRUCTION ACTIVITIES:

- ONCE EROSION AND SEDIMENT CONTROL MEASURES ARE IN PLACE, BEGIN LAND CLEARING FOLLOWED IMMEDIATELY BY ROUGH GRADING. DO NOT LEAVE LARGE AREAS UNPROTECTED FOR MORE THAN 14 DAYS. ALL DISTURBED AREAS THAT POTENTIALLY WILL BE IDLE FOR 14 DAYS OR MORE WILL BE STABILIZED (SEEDED, MULCHED, ETC.) IMMEDIATELY.
- AFTER COMPLETION OF MASS GRADING, FINAL GRADE AND SEED LANDSCAPE BERMS, AND SWALES IMMEDIATELY AFTER GRADING IS COMPLETED.
- UPON COMPLETION OF MASS GRADING, INSTALL SANITARY AND STORM SEWERS. AS STORM SEWERS ARE CONSTRUCTED, INSTALL INLET PROTECTION MEASURES. INSTALL RIPRAP UPON COMPLETION OF END SECTION INSTALLATION.
- UPON COMPLETION OF SEWER INSTALLATION AND INLET PROTECTION, PROCEED WITH ASPHALT PAVEMENT CONSTRUCTION.
- AS NECESSARY, LIVING OF ASPHALT PARKING SHOULD BE DONE PRIOR TO THE INSTALLATION OF STORM SEWERS TO PREVENT THE TRANSMISSION OF LIME DUST TO PONDS OR RECEIVING WATERS.
- CONTRACTOR SHALL MAINTAIN EROSION CONTROL MEASURES AND DEVICES DURING THE CONSTRUCTION PHASE AND UNTIL SILTATION OF THE STREETS AND STORM SEWERS WILL NO LONGER OCCUR.
- AFTER ALL DISTURBED AREAS HAVE BEEN STABILIZED, REMOVE ACCUMULATED SEDIMENT FROM INSTALLED EROSION CONTROL FEATURES.
- WHEN 70% OF VEGETATIVE COVER IS OBTAINED THE CONTRACTOR SHALL REMOVE ALL TEMPORARY EROSION AND SEDIMENT CONTROL MEASURES.

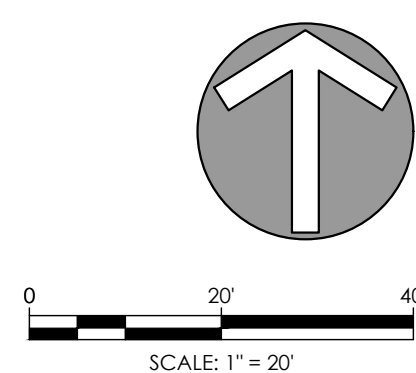

REVISION BLOCK



Michael Thompson

DATE

10/22/2021

DRAWN BY

HYC

CHECKED BY

TLP

HAMILTON
DESIGNS
A LIMITED LIABILITY COMPANY

11 Municipal Drive, Suite 300
Fishers, Indiana 46038
P. (317) 570-9800
www.hamilton-designs.com

CONSTRUCTION PLANS FOR:

ARBY'S | HEBER SPRINGS

1632 Heber Springs Road
Heber Springs, Arkansas 72543

RB AMERICAN GROUP, LLC

6200 Oak Tree Blvd., Suite 250
Independence, Ohio 44131

PROJECT NO.

2021-0122

DATE

10/22/2021

SCALE

1" = 20'

SHEET NAME

**STORMWATER POLL.
PREVENTION PLAN**

SHEET NO.

CE-101