

CORNER RECORD

Document Number CR 5669

City of OAKLAND County of ALAMEDA, California  
Brief Legal Description IRON PIN MONUMENT LOCATED WITHIN THE INTERSECTION OF E12TH STREET AND 22ND AVENUE. (15SE11)

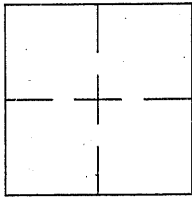

CORNER RECORD

Government Corner ☐ Control ☒  
Meander ☐ Property ☐  
Rancho ☐ Other ☐  
Date of Survey 05/14/13

COORDINATES  
(Optional)

N. \_\_\_\_\_  
E. \_\_\_\_\_  
Zone \_\_\_\_\_ Datum \_\_\_\_\_  
Elev. \_\_\_\_\_

Corner — Left as found ☒ Found and tagged ☐ Established ☐ Reestablished ☐ Rebuilt ☐

Identification and type of corner found: Evidence used to identify or procedure used to establish of reestablish the corner:  
FOUND IRON PIN MONUMENT LOCATED WITHIN THE INTERSECTION OF E12TH STREET AND 22ND AVENUE.

AS SHOWN ON CITY OF OAKLAND MONUMENT MAP, PAGE 151.

THIS POINT WAS REFERENCED PRIOR TO A CONSTRUCTION PROJECT IN THE VICINITY.

A description of the physical condition of the monument as found and as set or reset:  
FOUND AND SET POINTS AS SHOWN ON PAGE 2.

THESE TIES ARE FOR THE PURPOSE OF PERPETUATING THE FOUND MONUMENTATION.

NO CLAIM IS MADE AS TO THE RELATIONSHIP OF THE POINTS OR LINES SHOWN HEREON TO TRUE BOUNDARY LOCATIONS.

SURVEYOR'S STATEMENT

This Corner Record was prepared by me or under my direction in conformance with the Land Surveyors' Act on JUNE 7, 2013.  
Signed Vincent H. Cunha L.S. Number LS 4520



COUNTY SURVEYOR'S STATEMENT

This Corner Record was received 6-14-13 and examined  
and filed 8-2-13.  
Signed Russell R. Penland Title County Surveyor

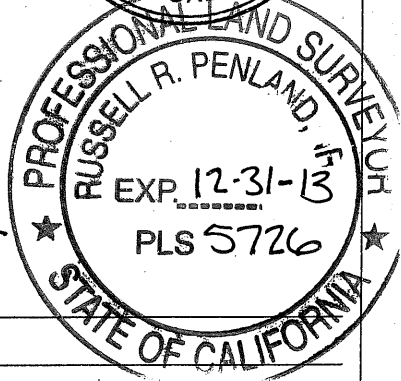

County Surveyor's Comment



SCALE: 1"=30'

## LEGEND

- FOUND IRON PIN IN MONUMENT WELL (15SE11)
- ✕ SET CUT CROSS IN CONCRETE
- AA##A# ALAMEDA COUNTY MONUMENT ID

