

TRACT NO 7452
MISSION GROVE CONDOMINIUMS

CONSISTING OF 18 SHEETS
BEING A ONE LOT CONDOMINIUM SUBDIVISION OF PARCEL 1 AS
SHOWN UPON THAT CERTAIN PARCEL MAP RECORDED IN BOOK 374
OF MAPS AT PAGE 28 SANTA CLARA COUNTY RECORDS

SAN JOSE CALIFORNIA

DATE MARCH 1983 SCALE 1"=10'

KIER & WRIGHT
CIVIL ENGINEERS & SURVEYORS INC
SANTA CLARA CALIFORNIA

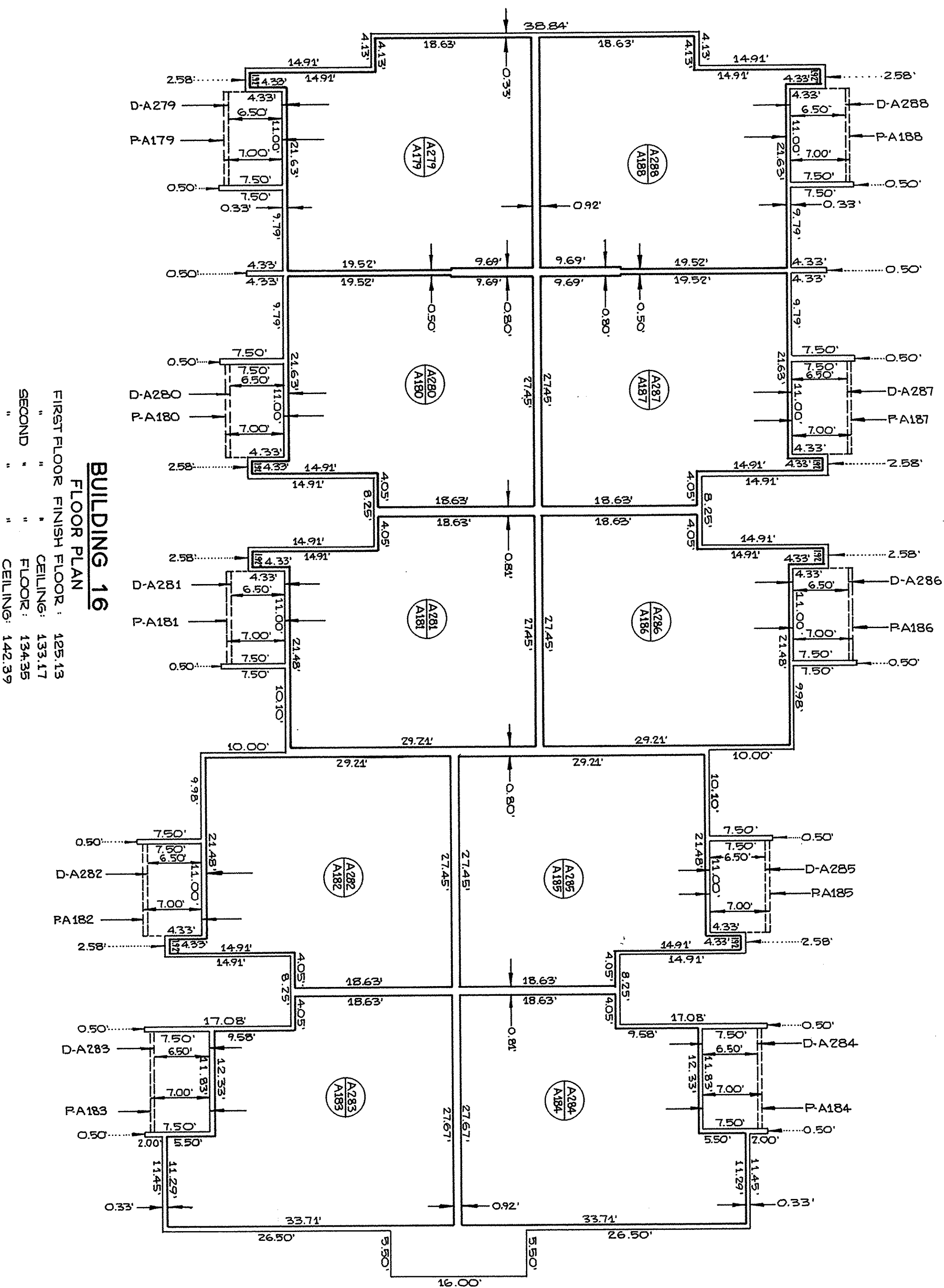

BUILDING 16

FLOOR PLAN

FIRST FLOOR FINISH FLOOR: 125.13
CEILING: 133.17
SECOND FLOOR: 134.35
CEILING: 142.39